

Astley & co

ESTATE AGENTS



Semi Detached Bungalow

South Facing Garden

Near the Bus-Stop

Two Bedrooms

No Onward Chain

Great Location



24 Leveson Road
Norwich, NR7 8NR

Guide Price £235,000

Entrance Hall

Entrance door, doors to all rooms

Bedroom 1 11' 11" x 11' 8" (3.621m x 3.552m)

Window to front, radiator

Bedroom 2 11' 6" x 8' 11" (3.5m x 2.713m)

Window to front, radiator

Kitchen 11' 5" x 11' 0" (3.491m x 3.362m)

Window to rear, comprising a range of base and wall units, sink and drainer, space for fridge freezer, space and plumbing for washing machine, cooker, splashbacks

Lounge 14' 11" x 11' 11" (4.549m x 3.642m)

Sliding doors to rear, fireplace, radiator

Garage

Detached garage with side opening doors

Garden

Enclosed rear garden

Score	Energy rating	Current	Potential
92+	A		
81-91	B		
69-80	C		77 C
55-68	D	67 D	
39-54	E		
21-38	F		
1-20	G		

GROUND FLOOR
575 sq.ft. (53.4 sq.m.) approx.

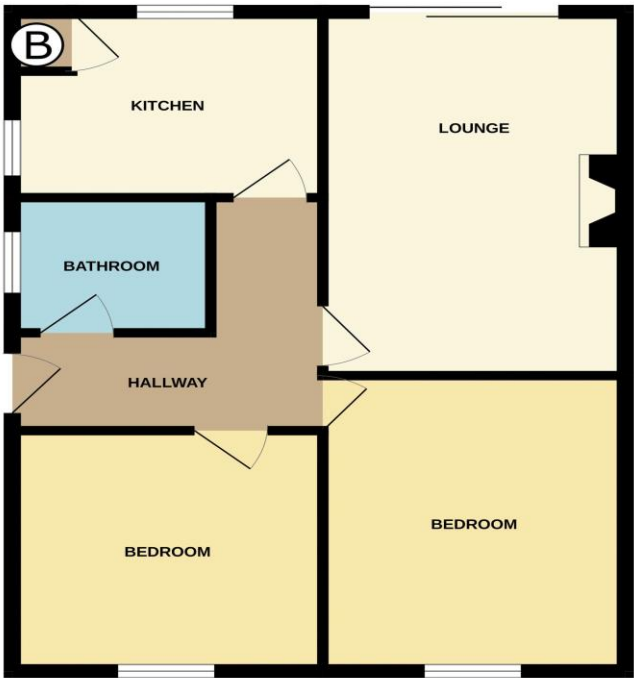

TOTAL FLOOR AREA : 575 sq.ft. (53.4 sq.m.) approx.
Whilst every attempt has been made to ensure the accuracy of the floorplan contained here, measurements of doors, windows, rooms and any other items are approximate and no responsibility is taken for any error, omission or mis-statement. This plan is for illustrative purposes only and should be used as such by any prospective purchaser. The services, systems and appliances shown have not been tested and no guarantee as to their operability or efficiency can be given.
Made with Metropix ©2025

Astley & Co Estate Agents

Email: yvonne@astleyandco.com

Website: www.astleyandco.com

Tel: 01603 415182

We wish to inform you that these particulars are set out as a general outline and do not constitute any part of an offer or contract. We have not tested any services, appliance or equipment and no warranty is given or implied that these are in working order. Fixtures, fittings and furnishings are not included unless specifically described. All measurements, distances and areas are approximate and for guidance only. It should not be assumed that the property remains the same as shown in the photographs.

